

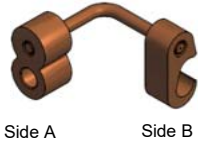

INFORMATION SHEET
GGB SERIES
Grounding and Bonding Equipment
Compression Connectors for Copper Conductors
Suitable for Direct Burial in Earth or Concrete



Catalog Number	Side A		Side B		Installation Tools										
	Cu Ground Rod Size	Rebar Size	Galvanized Steel Ground Rod Size	Copper Wire Size	ILSCO				UTILCO	Ridgid	Greenlee	Thomas & Betts	Burndy		
					ILC-12-N, ILC-12H-N, ILCB-12 Series, ILC-750, ILC-14 Series, ILC-15 Series, TM-12U1000, TR-12U1000, TB-12U1000 Series		ILC-12, ILC-12H		UM-U42, UR-U42, BLL-U42 Series	RE 12-M	EK1240, HK1240, RK1240, RK1550	13100A, TBM14 Series, TBM15 Series, BPLT14 Series, BPLT15 Series	Y45 Series, Y46 Series, PAT46 Series, Y750 Series, PAT750 Series	Y35 Series, Y39 Series	
					Die Index (# Crimps)		Die Index (# Crimps)		Die Index (# Crimps)						
				Side A	Side B	Side A	Side B	Side A	Side B	Side A	Side B	Side A	Side B		
GGB-1	1/2"	#3	-	2 - 250 kcmil	998 (1)	997 (1)	998 (1)	997 (1)	998 (1)			997 (1)	998 (1)	997 (1)	
GGB-2	5/8"	#4	-	2 - 250 kcmil	998 (1)	997 (1)	998 (1)	997 (1)	998 (1)			997 (1)	998 (1)	997 (1)	
GGB-3	3/4"	#5	-	2 - 250 kcmil	998 (1)	997 (1)	998 (1)	997 (1)	998 (1)			997 (1)	998 (1)	997 (1)	
GGB-3TN	-	-	3/4"	2 - 250 kcmil	998 (1)	997 (1)	998 (1)	997 (1)	998 (1)			997 (1)	998 (1)	997 (1)	
GGB-4	1"	#6 - 7	-	2 - 250 kcmil	998 (1)	997 (1)	N/A	997 (1)	998 (1)			997 (1)	N/A	997 (1)	
GGB-5	1/2"	#3	-	250 kcmil - 500 kcmil	998 (1)	998 (1)	998 (1)	N/A	998 (1)			998 (1)	998 (1)	N/A	
GGB-6	5/8"	#4	-	250 kcmil - 500 kcmil	998 (1)	998 (1)	998 (1)	N/A	998 (1)			998 (1)	998 (1)	N/A	
GGB-6TN	-	-	5/8"	250 kcmil - 500 kcmil	998 (1)	998 (1)	998 (1)	N/A	998 (1)			998 (1)	998 (1)	N/A	
GGB-7	3/4"	#5	-	250 kcmil - 500 kcmil	998 (1)	998 (1)	998 (1)	N/A	998 (1)			998 (1)	998 (1)	N/A	
GGB-8	1"	#6 - 7	-	250 kcmil - 500 kcmil	998 (1)	998 (1)	N/A	N/A	998 (1)			998 (1)	N/A	N/A	

GGB Series compression ground grid cross connector can be used to connect a copper ground grid system together or to connect a copper ground grid system to a copper clad ground rod. They allow adjustment of each side of the connector prior to installation. They are pre-filled with inhibiting compound and are suitable for direct burial.

Notes:

1. Either ILSCO or Burndy Type U and P Dies can be used to install this product.
2. ILSCO and Burndy Type U-dies are designed to be used in crimping tools that apply at least 12-tons of pressure. Crimping ILSCO connectors with U-type dies in tools with less than 12-tons of pressure results in connections that do not meet ILSCO's design requirements for the system. Tools with less than 12-tons of pressure should not be used with U-type dies.
3. Adapter is required when using ILSCO ILC-15, Greenlee RK1550, Thomas & Betts TBM15, BPLT15, Burndy Y45, Y46 or PAT46 crimp tools.
4. When used with ground rod/rebar, it is recommended to rough up the end of ground rod/rebar where GGB is to be placed. This provides good rotational resistance. Perform a "pre-crimp" on ground rod/rebar prior to installing GGB connector. Use an indent type of die such as ILSCO's ILD-PRECRIMP, Burndy's U2CABT (Die Index # 348) or UPRECRIMP-12, -58, -34.*
5. Each side of the GGB Series may be rotated around the ground rod/rebar to any desired position before crimping.
6. GGB -TN Series are specifically designed to be used to with Galvanized Steel Ground Rod.

* "U2CABT" and "UPRECRIMP" are registered trademarks TM of Burndy/FCI.